



# PATTON & COOKE Swage Connectors



Patton & Cooke is proud to offer a line of Travis Pattern high strength aluminum Swage Connectors for your substation needs. Swage connectors are the optimal choice for a quick, safe and reliable connection. The "crimp style" connection is made without the need for welding, thus reducing install time and eliminating hazards from welding (gases, chemicals, and molten metals).

FEATURES	BENEFITS
• High strength aluminum connectors	• Safer - no hazards from welding
• Swage die sizes clearly marked for ease of installation	• Faster - connection can be completed in minutes
• Manufactured to NEMA CC1 standards	• Consistant repeatable connections
• Lightweight	• Install in any weather - rain, snow, sleet, wind
• High conductivity, corrosion resistant	• Verified connections with easy to use gauge
• Superior mechanical, thermal and electrical connection compared to welded/bolted connectors	• Reduced project costs from time saved - no need for welding

Available in different angles – side formed (standard), angled as required, 90 °, centered.

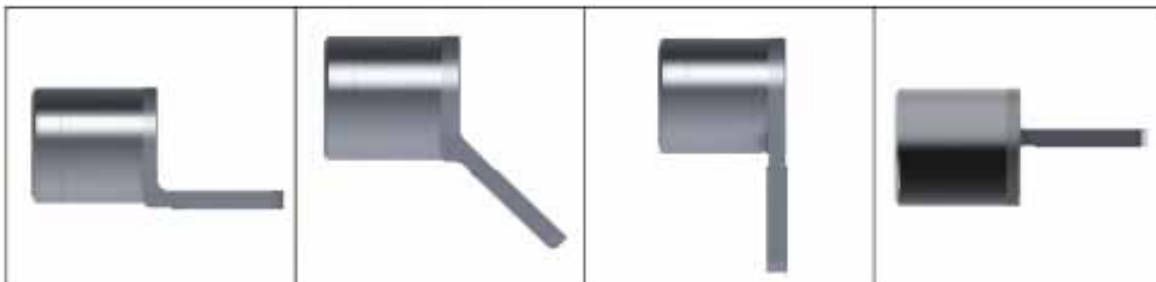

## AVAILABLE CONNECTORS

Pipe Connectors	Pipe Expansion Connectors	Cable Connectors
Pipe to Flat Pad	Pipe to Flat Pad Expansion	Cable to Flat Pad
Pipe to Pipe Tee	Pipe to Pipe Bus Support Expansion	Cable to Pad Tee
Pipe to Angled Pipe Tee	Pipe to Flat Pad Expansion	Double Cable to Flat Pad
Pipe to Double Pipe V	Pipe to Flat Pad Expansion	Cable to Cable Tee
Pipe to Double Pipe Y	Expansion Terminal to Pipe	
Pipe to Pipe Coupler		
Pipe to Flat Pad Tee		
Pipe to Pipe Elbow		
Grounding Stud		
External End Plug		



## SWAGE TOOL



Patton & Cooke is also pleased to offer the Travis Swage Tool. Travis Swage tooling is designed to be used with all swage connectors fitting the parameters of Travis swage inspection gauges. The Travis Swage Tool uniformly compresses swage fittings to make permanent, long lasting connections. Made for use in all weather and climates. The ultimate time & money saver, making permanent connections in minutes.

### FEATURES

- PE172 110 Volt Electric Pump
- Automatic Pressure Switch
- 10" Non-conductive hydraulic hose
- 2.5" DIA Dial Pressure Gauge
- Fittings pre-installed to work with all Travis Swage Tools

No lengthy inspections or x-ray machines required to ensure secure connection. Simply use the swage inspection gauges to check a proper connection has been made. The gauges are a basic pass or fail gauge. If the swage is within the parameters on the inspection gauge, the connection is complete.



## BUS INSPECTION GAUGE      CABLE INSPECTION GAUGE

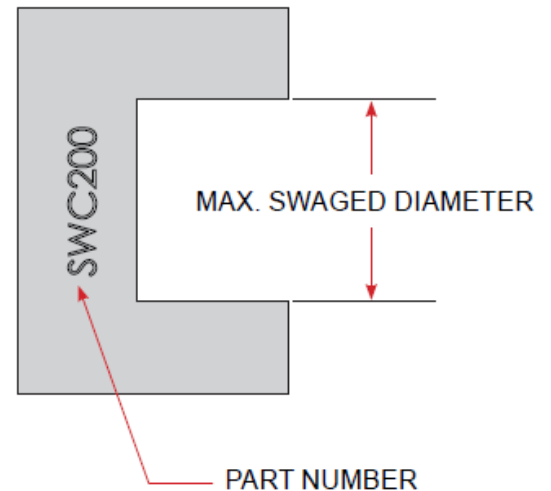
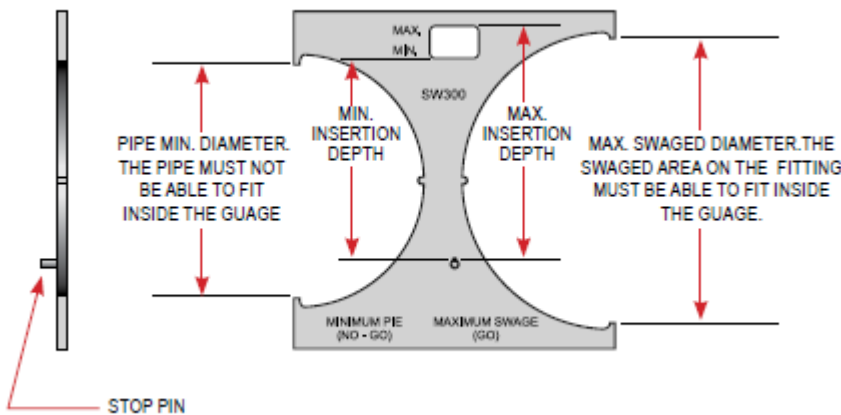

Contact Patton & Cooke to place your order or for more information about Swage Connectors & Tools