

# PATTON & COOKE ACCESSORIES

## GASKET REPLACEMENT SETS

Patton & Cooke's Gasket Sets provide exceptional value as genuine replacement parts. Using these parts will maximize coupler life by helping to achieve optimal performance.



### C06 - 250 Amp Series

Each Patton & Cooke GA-V196 Gasket Set includes all the gaskets and seals required for any on C06 coupler series.

- C06 Series - 250 Amp Series

- |                                      |   |
|--------------------------------------|---|
| 1 (2) "O" Ring-Phase Insulator Plate | 5 (1) Gasket Receptacle Cover             |
| 2 (2) "O" Ring-Gnd Stem              | 6 (3) Gasket Phase Stems Plug & Recept    |
| 3 (1) "O" Ring-Gnd Stem              | 7 (1) Instant Adhesive for Items 4 &/or 5 |
| 4 (1) Gasket Plug Interface          |   |

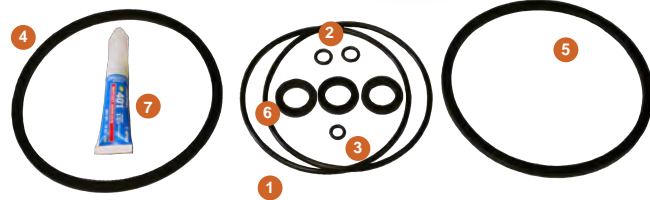

### PK/PL - 250/400 Amp Series

Each Patton & Cooke GA-V193 Gasket Set includes all the gaskets and seals required for any on PK/RK or PL/RL coupler series.

- PK/RK Series 5/8 kV 250 Amp • PL/RL Series 5 kV 400 Amp

- |                              |                               |                                     |
|------------------------------|-------------------------------|-------------------------------------|
| 1 (3) Phase Stem Gasket      | 5 (1) Adhesive                | 9 (1) Front to Rear Body Gasket     |
| 2 (3) Phase Stem Gasket      | 6 (1) Entrance Fitting Gasket | 10 (2) Ground Stem Gasket           |
| 3 (1) Pilot Stem Gasket      | 7 (1) Cover/Hood Gasket       | 11 (3) Receptacle Phase Stem Gasket |
| 4 (1) Pilot Insulator Gasket | 8 (1) Phase Insul for Gasket  | 12 (3) Plug Phase Stem Gasket       |

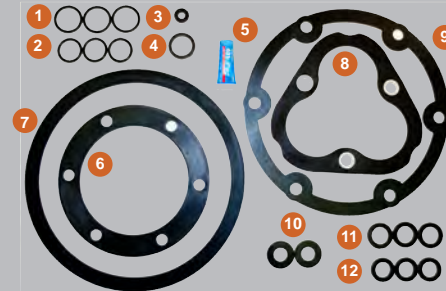

### C80 - 250/400 Amp Series

Each Patton & Cooke GA-V194 Gasket Set includes all the gaskets and seals required for any one C80 coupler series.

- C80C - 250 Amp Series • C80D - 400 Amp Series

- |                                 |                               |                              |
|---------------------------------|-------------------------------|------------------------------|
| 1 (3) Phase Stem Gasket         | 5 (1) Cover/Hood Gasket       | 8 (1) Pilot Stem Gasket      |
| 2 (3) Phase Stem Gasket         | 6 (1) Entrance Fitting Gasket | 9 (1) Pilot Insulator Gasket |
| 3 (1) Front to Rear Body Gasket | 7 (1) Adhesive                | 10 (2) Ground Stem Gasket    |
| 4 (3) Phase Insulator Gasket    |                               |                              |

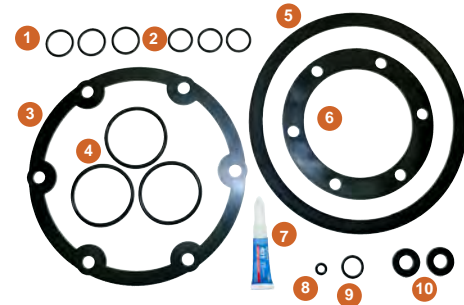

### C150/C80 - 500 Amp Series

Each Patton & Cooke GA-V195 Gasket Set includes all the gaskets and seals required for any one C150 or C80F coupler series.

- C150F - 500 Amp Series • C80F - 500 Amp Series

- |                                    |  |
|------------------------------------|--|
| 1 (1) Cover/Hood Gasket            | 5 (1) Pilot Stem Gasket (Large Style)        |
| 2 (1) Entrance Fitting Gasket      | 6 (2) Body Ground & Pilot Stem (Small Style) |
| 3 (2) Phase Insulator Plate Gasket | 7 (1) Adhesive                               |
| 4 (3) Insulator Tube Seals         | 8 (4) Phase & Ground Stem Gasket             |



*\*All kits are designed for standard contact arrangement.  
If you have additional pilot or ground contacts,  
additional materials may be required.\**



#100 - 7795 128th Street  
Surrey, BC • V3W 4E6 • Canada  
Email: [contact@pattonandcooke.com](mailto:contact@pattonandcooke.com)  
Web: [pattonandcooke.com](http://pattonandcooke.com)

**GENUINE**  
**PATTON & COOKE**  
**REPLACEMENT PARTS**  
PATTON & COOKE COMPANY

Call 1.866.591.5374 (N. America) or 604.591.5374 for more Info